

- Key:**
- Quantity - 5  
Column - 10m Stainton (P/T)  
Lantern - Philips Mini-Tridium SGG451 GB  
Optic - VX2 IT2 P1 Lamp - 60W CPO
  - Quantity - 7  
Column - 8m Stainton (P/T)  
Lantern - Philips Mini-Tridium SGG451 GB  
Optic - VX2 IT2 P1 Lamp - 45W CPO
  - Quantity - 1  
Illuminated **Twin-Headed** Traffic Sign  
Column - 4.2m Stainton  
Signlight - Enterprise LED  
Lamp - LED 3W
  - Quantity - 3  
Illuminated **Single-Headed** Traffic Sign  
Column - 4.2m Stainton  
Signlight - Enterprise LED  
Lamp - LED 3W
  - Quantity - 1  
Solar Powered Bollard  
Bollard - Signature Trueflex  
Face - Keep Left
  - Quantity - 1  
Pedestrian Crossing Beacon (Combined)  
Column - 6m  
Beacon - Simmons Signs Midul LED  
with **Shrouds**  
Lantern - WRTL ARC-X FG 45W CPO
  - Quantity - 1  
Existing Pedestrian Crossing Belisha  
Beacon (Combined) unit to remain  
Column - Clean, paint & wrap  
Beacon - Replace with Simmons Signs  
Modul LED unit with **shrouds**  
Lantern - WRTL ARC-X FG 45W CPO
  - Quantity - 2  
Existing VMS sign to remain
  - Quantity - 18  
Existing non DTC lighting column to be  
removed to tip off site
  - Quantity - 1  
Existing non DTC wall bracket to be  
removed to tip off site
  - Quantity - 3  
Existing non DTC Illuminated Single-Headed  
Traffic Sign to be removed to tip off site
  - Quantity - 1  
Existing non DTC Illuminated Twin-Headed  
Traffic Sign to be removed to tip off site
  - Quantity - 1  
Existing non DTC Illuminated Bollard to be  
removed to tip off site
  - Quantity - 1  
Existing non DTC Pedestrian Crossing  
Belisha Beacon to be removed to tip off site
  - N New DNO Supply x 5
  - T Transfer of DNO Supply x 3
  - TC Transfer Coordinated of DNO Supply x 3
  - TC1 Transfer Coordinated 1 of DNO Supply x 7
  - D Disconnection of DNO Supply x 12
  - WARNING - BURIED HV CABLES IN CLOSE PROXIMITY TO APPARATUS
  - DRAWING / VIEW EXTENTS LINE

**Notes:**  
WARNING - THERE ARE BURIED HV CABLES WITHIN THIS SCHEME

ALL WORKS IN PROXIMITY TO HIGH VOLTAGE CABLES SHOULD BE SUBJECT TO A PRE-SITE INVESTIGATION BY OPERATIONS

PROPOSED GIVE WAY SIGN (TSRGD 602) TO BE LOCATED NO MORE THAN 12M FROM GIVE WAY LINES.

CE5 TOWN CENTRE / CONFLICT AREA P6 TRAFFIC ROUTE

COPYRIGHT RESERVED BALFOUR BEATTY WORKPLACE IS THE OWNER OF THE COPYRIGHT SUBSISTING IN THESE DRAWINGS, PLANS, DESIGNS AND SPECIFICATIONS. THEY MUST NOT BE USED, REPRODUCED OR COPIED, IN WHOLE OR IN PART, NOR MAY THE INFORMATION, IDEAS AND CONCEPTS THEREIN CONTAINED (WHICH ARE CONFIDENTIAL TO BALFOUR BEATTY WORKPLACE) BE DISCLOSED TO ANY PERSON WITHOUT THE PRIOR SPECIFIC WRITTEN CONSENT OF BALFOUR BEATTY WORKPLACE.

**streetlighting**

Designer PW 01914131373 Date of issue 23/04/15  
07780680424

Checked JH Authorized AK Sheet Size A1 Scale 1:500 @ A1

Issue PRELIMINARY Revision ORIG.

Drawing no. 8200-2299-V1

Scheme Name and Ward: NEWTON ROAD Rushden

Streets on drawing: NEWTON ROAD DWG 1 of 3

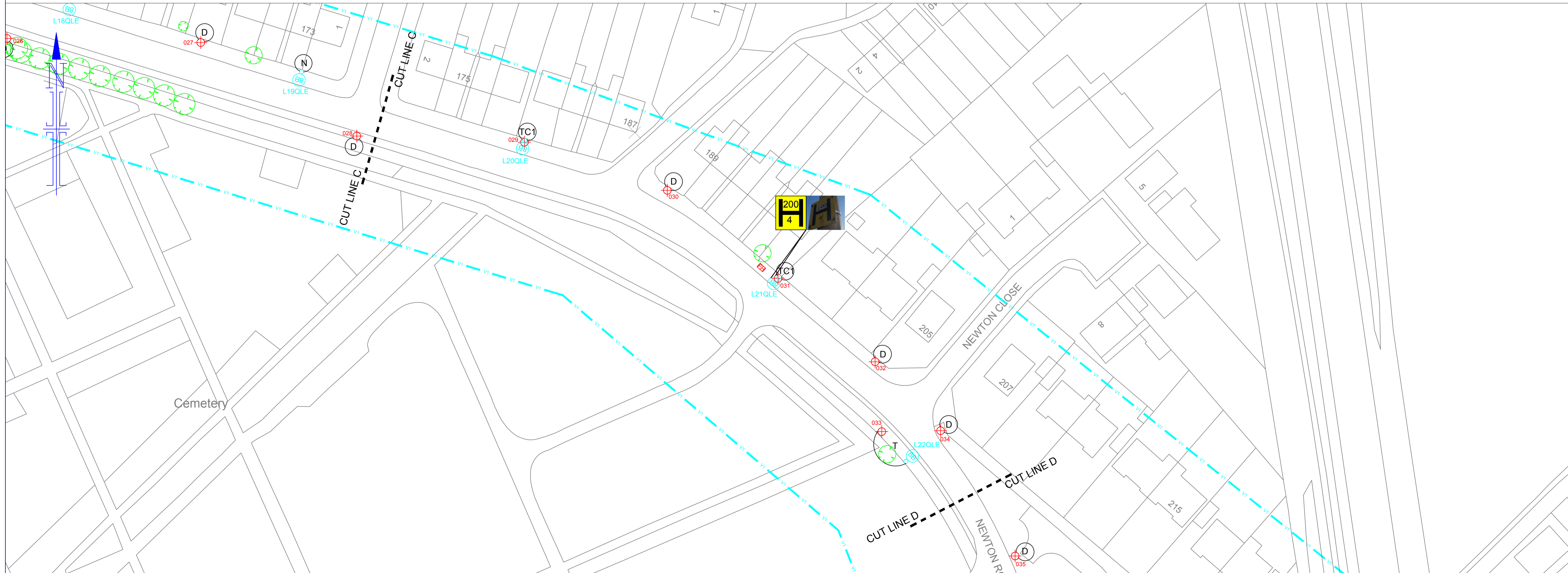
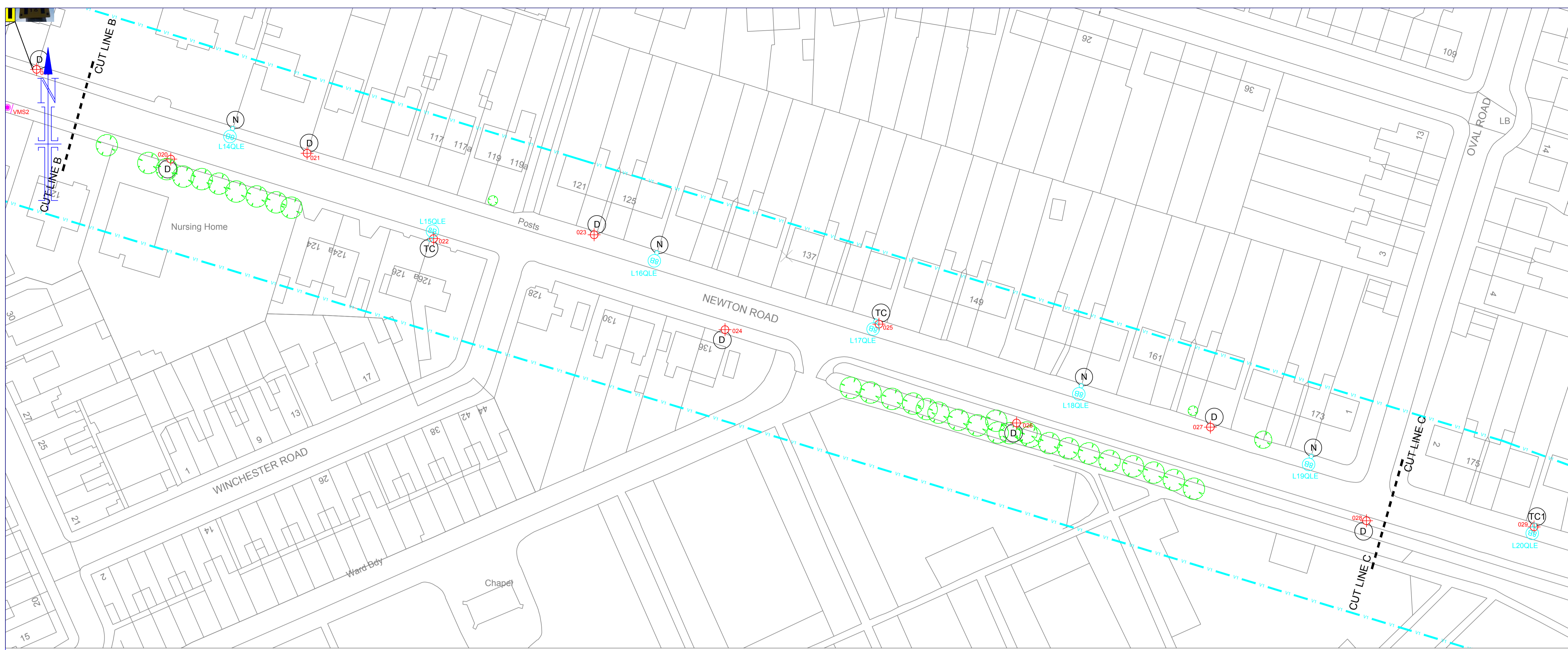

- Key:**
- (9B) Quantity - 9  
Column - 8m Stalton (P/T)  
Lantern - Philips Mini-Iridium SGS451 GB  
Optic - VX2 IT2 P1 Lamp - 45W CPO
  - ⊕ Quantity - 15  
Existing non DTC lighting column to be removed to tip off site
  - N New DNO Supply x 4
  - T Transfer of DNO Supply x 1
  - TC Transfer Coordinated of DNO Supply x 2
  - TC1 Transfer Coordinated 1 of DNO Supply x 2
  - D Disconnection of DNO Supply x 10
  - ⚠ WARNING - BURIED HV CABLES IN CLOSE PROXIMITY TO APPARATUS
  - DRAWING / VIEW EXTENTS LINE

**Notes:**

WARNING - THERE ARE BURIED HV CABLES WITHIN THIS SCHEME

ALL WORKS IN PROXIMITY TO HIGH VOLTAGE CABLES SHOULD BE SUBJECT TO A PRE-SITE INVESTIGATION BY OPERATIONS

P6 TRAFFIC ROUTE

COPYRIGHT RESERVED BALFOUR BEATTY WORKPLACE IS THE OWNER OF THE COPYRIGHT SUBSISTING IN THESE DRAWINGS, PLANS, DESIGNS AND SPECIFICATIONS. THEY MUST NOT BE USED, REPRODUCED OR COPIED, IN WHOLE OR IN PART, NOR MAY THE INFORMATION, IDEAS AND CONCEPTS THEREIN CONTAINED (WHICH ARE CONFIDENTIAL TO BALFOUR BEATTY WORKPLACE) BE DISCLOSED TO ANY PERSON WITHOUT THE PRIOR SPECIFIC WRITTEN CONSENT OF BALFOUR BEATTY WORKPLACE.

<b>streetlighting</b>	
Designer	PW 01914131373 07780680424
Date of issue	23/04/15
Checked	JH AK A1
Authorised	A1
Sheet Size	Scale
1:500 @ A1	
Issue	Revision
PRELIMINARY	ORIG.

Drawing no.  
**8200-2299-V1**

Scheme Name and Ward:  
**NEWTON ROAD  
Rushden**

Streets on drawing:  
**NEWTON ROAD  
DWG 2 of 3**

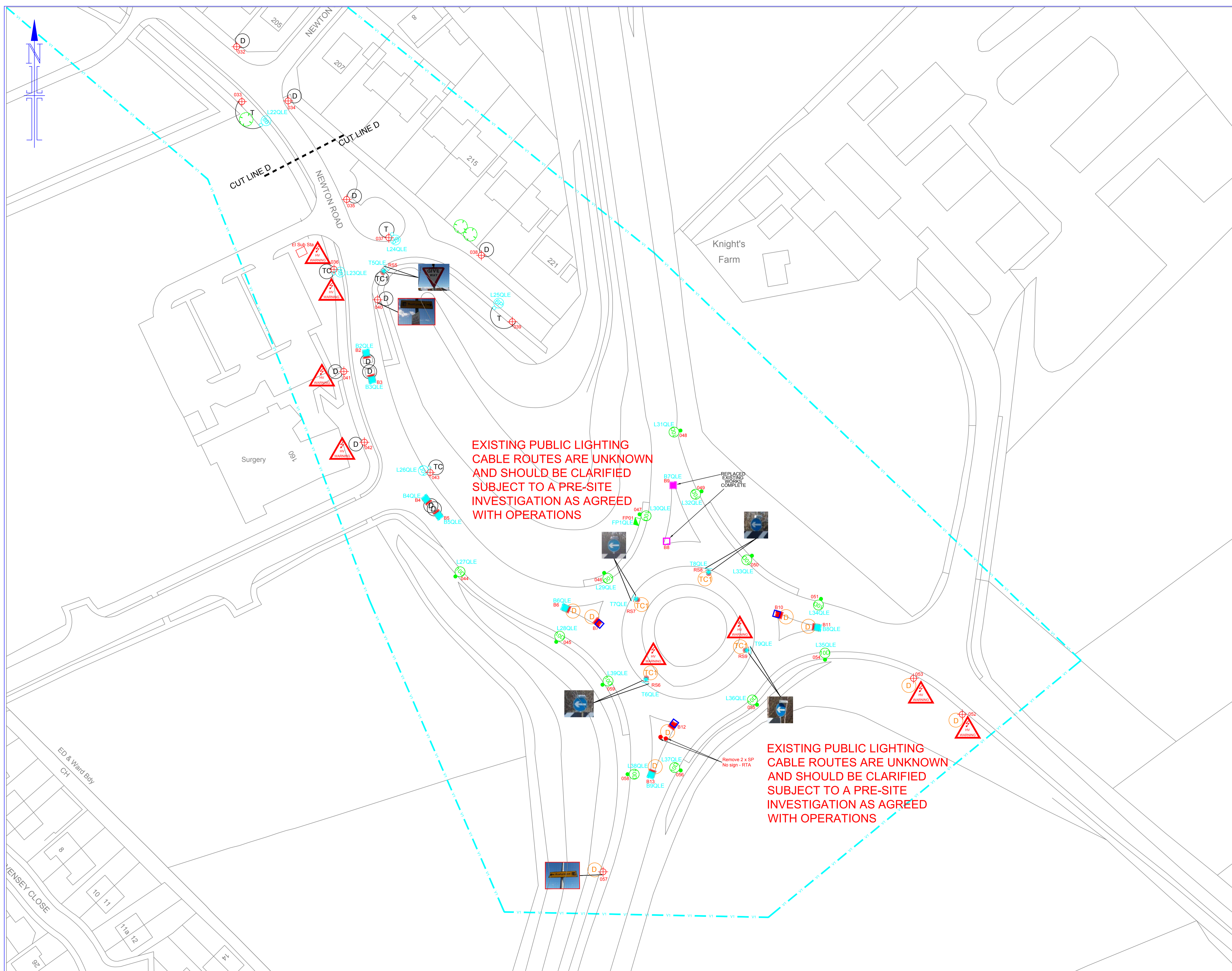

EXISTING PUBLIC LIGHTING  
CABLE ROUTES ARE UNKNOWN  
AND SHOULD BE CLARIFIED  
SUBJECT TO A PRE-SITE  
INVESTIGATION AS AGREED  
WITH OPERATIONS

EXISTING PUBLIC LIGHTING  
CABLE ROUTES ARE UNKNOWN  
AND SHOULD BE CLARIFIED  
SUBJECT TO A PRE-SITE  
INVESTIGATION AS AGREED  
WITH OPERATIONS

- Key:**
- Quantity - 1  
Column - 10m Stainton (P/T)  
Lantern - Philips Mini-Iridium SG5451 GB  
Optic - VX2 IT2 P1 Lamp - 60W CPO
  - Quantity - 1  
Column - 8m Stainton (P/T)  
Lantern - Philips Mini-Iridium SG5451 GB  
Optic - VX2 IT2 P1 Lamp - 45W CPO
  - Quantity - 2  
Column - 6m Stainton (P/T)  
Lantern - WRTL Libra 65  
Optic - Factory Set Lamp - 36W PL-L
  - Quantity - 13  
Column - 10m Proposed DTC (Stub Bracket)  
Lantern - Philips Mini-Iridium SG5451 GB  
Optic - VX2 IT2 P1 Lamp - 60W CPO
  - Quantity - 5  
Illuminated Single-Headed Traffic Sign  
Column - 4.2m Stainton  
Signlight - Enterprise LED  
Lamp - LED 3W
  - Quantity - 7  
Solar Powered Bollard  
Bollard - Signature Trueflex  
Face - Keep Left
  - Quantity - 3  
Non-Illuminated Bollard  
Bollard - SignPost Solutions SPS360  
Face - Plain Face
  - Quantity - 1  
Existing works Completed  
Bollard to remain  
Face - Keep Left
  - Quantity - 1  
Existing works Completed  
Bollard to remain  
Face - Plain Faced
  - Quantity - 1  
Existing Proposed DTC Feeder Pillar
  - Quantity - 12  
Existing non DTC lighting column to be removed to tip off site
  - Quantity - 5  
Existing non DTC Illuminated Single-Headed Traffic Sign to be removed to tip off site
  - Quantity - 10  
Existing non DTC Illuminated Bollard to be removed to tip off site
  - Quantity - 2  
Existing 76mm Sign Post (Non-Illuminated) to be removed to tip off site
  - Transfer of DNO Supply x 2
  - Transfer Coordinated of DNO Supply x 2
  - Transfer Coordinated 1 of DNO Supply x 1
  - Transfer Coordinated 1 of PL/LA Supply x 4
  - Disconnection of DNO Supply x 9
  - Disconnection PL / LA Supply x 9
  - WARNING - BURIED HV CABLES IN CLOSE PROXIMITY TO APPARATUS
  - DRAWING / VIEW EXTENTS LINE

**Notes:**

WARNING - THERE ARE BURIED HV CABLES WITHIN THIS SCHEME

ALL WORKS IN PROXIMITY TO HIGH VOLTAGE CABLES SHOULD BE SUBJECT TO A PRE-SITE INVESTIGATION BY OPERATIONS

PROPOSED GIVE WAY SIGN (TSRGD 602) TO BE LOCATED NO MORE THAN 12M FROM GIVE WAY LINES.

CE5 CONFLICT AREA / P6 TRAFFIC ROUTE

COPYRIGHT RESERVED BALFOUR BEATTY WORKPLACE IS THE OWNER OF THE COPYRIGHT SUBSISTING IN THESE DRAWINGS, PLANS, DESIGNS AND SPECIFICATIONS. THEY MUST NOT BE USED, REPRODUCED OR COPIED, IN WHOLE OR IN PART, NOR MAY THE INFORMATION, IDEAS AND CONCEPTS THEREIN CONTAINED (WHICH ARE CONFIDENTIAL TO BALFOUR BEATTY WORKPLACE) BE DISCLOSED TO ANY PERSON WITHOUT THE PRIOR SPECIFIC WRITTEN CONSENT OF BALFOUR BEATTY WORKPLACE.

**streetlighting**

Designer	PW	01914131373 07780680424	Date of issue	23/04/15
Checked	JH	AK	Sheet Size	A1
Authorised			Scale	1:500 @ A1
Issue	PRELIMINARY			Revision
				ORIG.
Drawing no.	8200-2299-V1			
Scheme Name and Ward:	NEWTON ROAD Rushden			
Streets on drawing:	NEWTON ROAD DWG 3 of 3			